

# REVELANDO SÃO PAULO - 2026

## APRENDI COM MEUS AVÓS

### BARRACA COMIDA COM PREPARO CORES:

estrutura metálica: **MARROM CAFÉ**  
 fechamentos em madeira: **AMARELO JASMIM**

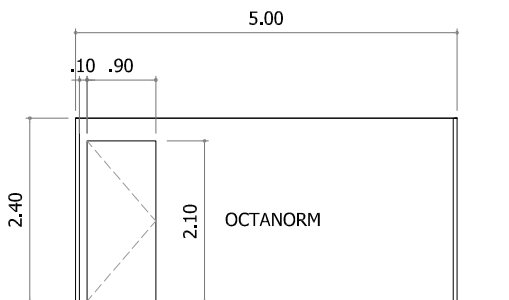

**VISTA INTERNA**

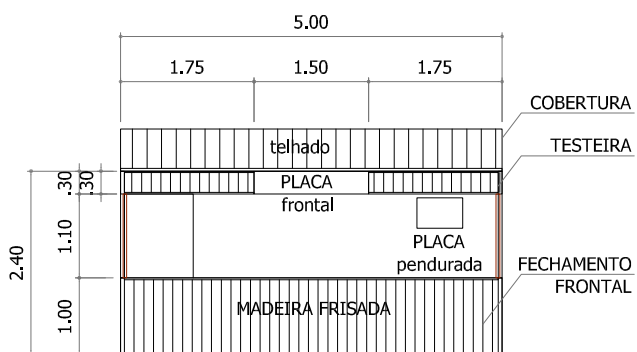

**VISTA FRONTAL**

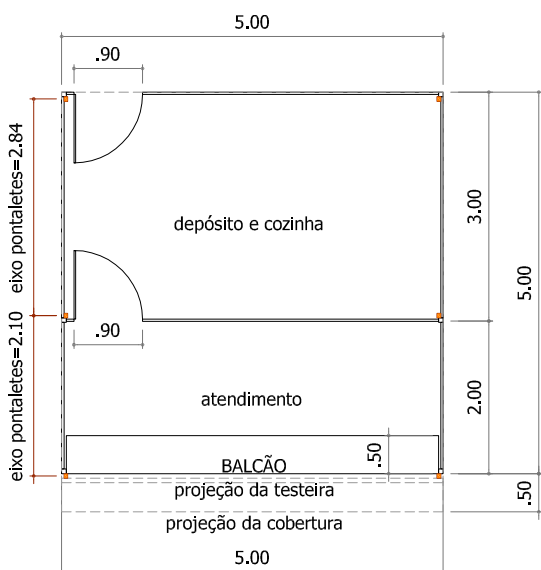

**PLANTA**

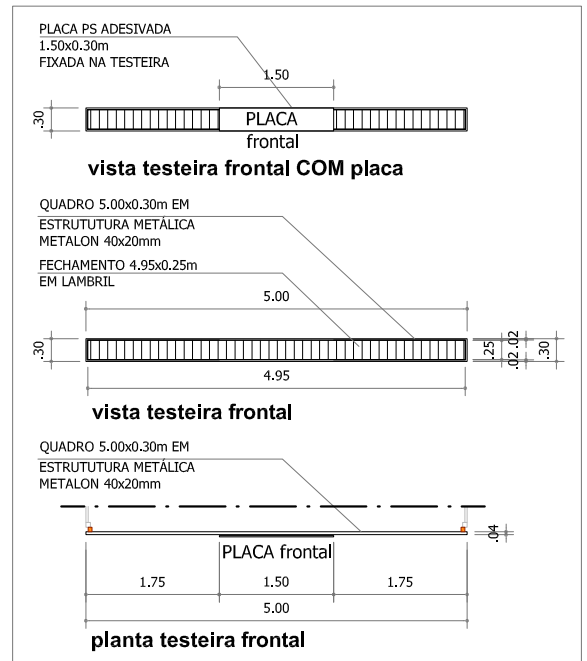

**TESTEIRA (detalhamento)**  
 cor estrutura metálica: marrom café  
 cor lambril de madeira: amarelo jasmim

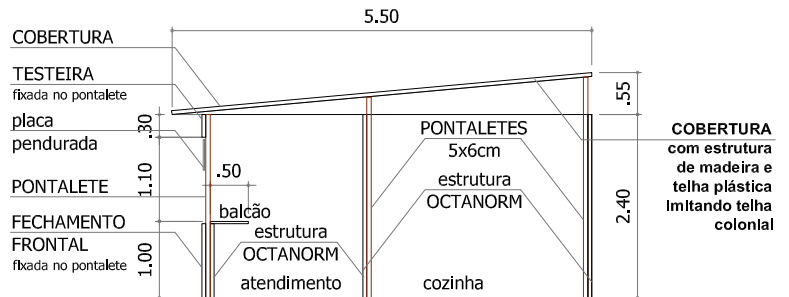

**CORTE ESQUEMÁTICO**

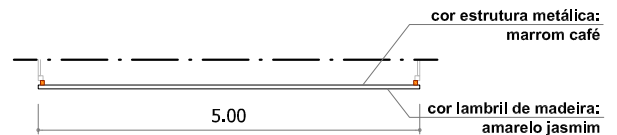

**PLANTA Fechamento Frontal**

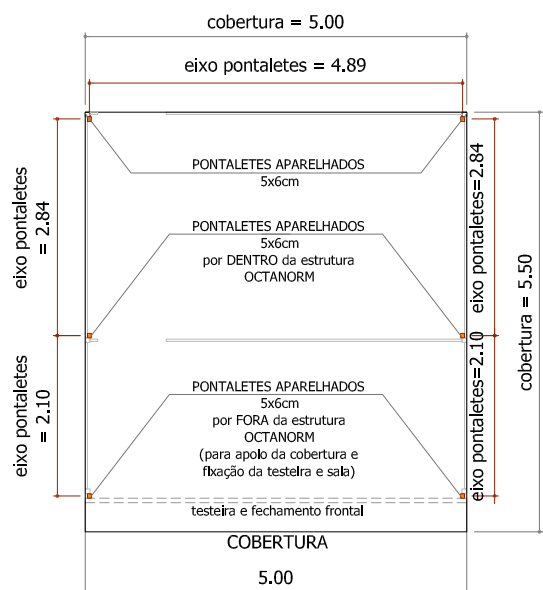

**PLANTA ESTRUTURA COBERTURA**